

The Light Box at Goldman Warehouse TECH SPECS

Welcome!

The Light Box is a collaborative space filled with like – minded yet distinctly different organizations. The Light Box is a laboratory, a place where artists from here and abroad can experiment, take risks, and develop their artistic vision. The Light Box contains a 3,128 SF Black Box, a 1,160 SF White Box, and Exhibition galleries throughout.

Technical Specifications

Entrances

Visitors entrance	Open to public during business hours M-F 9am-5pm
Theatre Entrance (ADA Accessible)	Open to public during events only
Employees Entrance	Not open to public

House Seating Capacity

Studio A / Black Box Theatre	200
Studio B / Rehearsal Room	60

Dimensions

Black Box Theatre	4,250 SF
White Box Rehearsal Room	1,160 SF
Box Office/Lobby	600 SF
Exhibition Corridor	700 SF
Lobby/Bar	750 SF

Stage Dimensions

White Box / Studio B Grid System

Grid Height.....15'

Staging area.....29' x 28'

NOTE: Please request a stage diagram from the Technical Director for obstructions.

Black Box / Studio A Grid System

Grid Height 12'5"
Type Fixed Grid
House Pipes 8 - 40' long; 2 - 60' long; 1 - 25' long
Traveler Tracks 1 available
Staging area..... 28'x28'

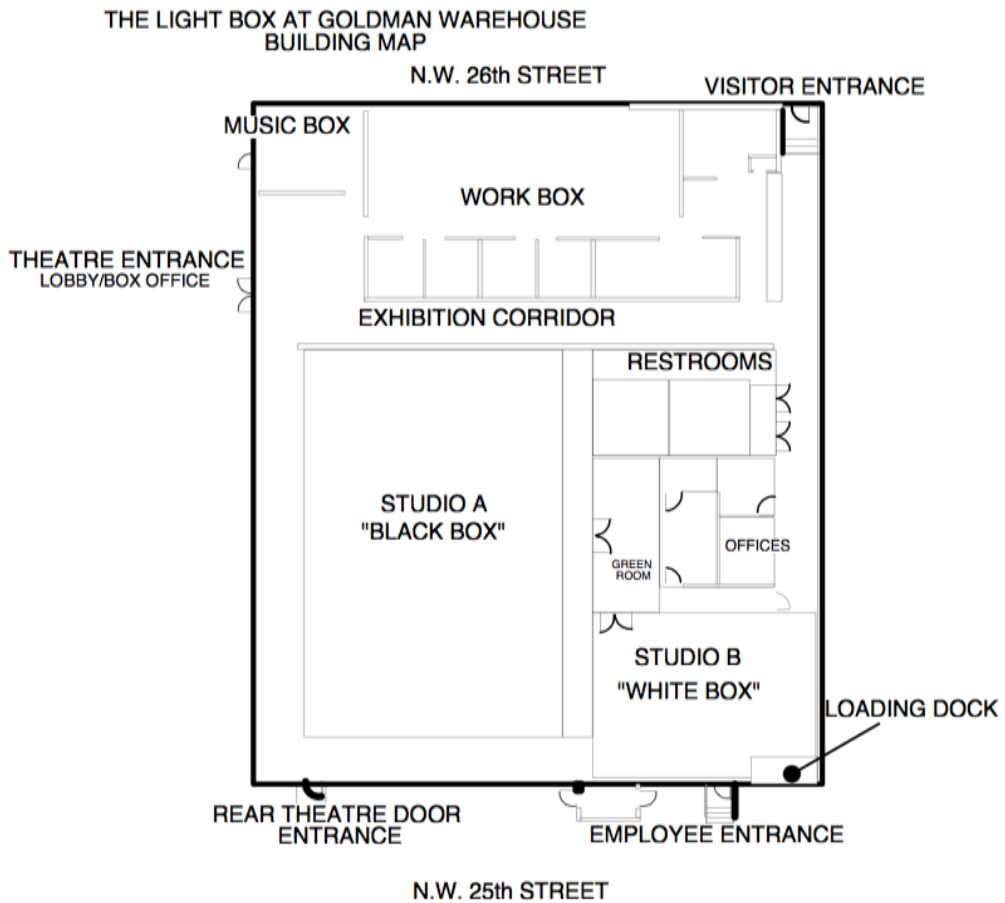

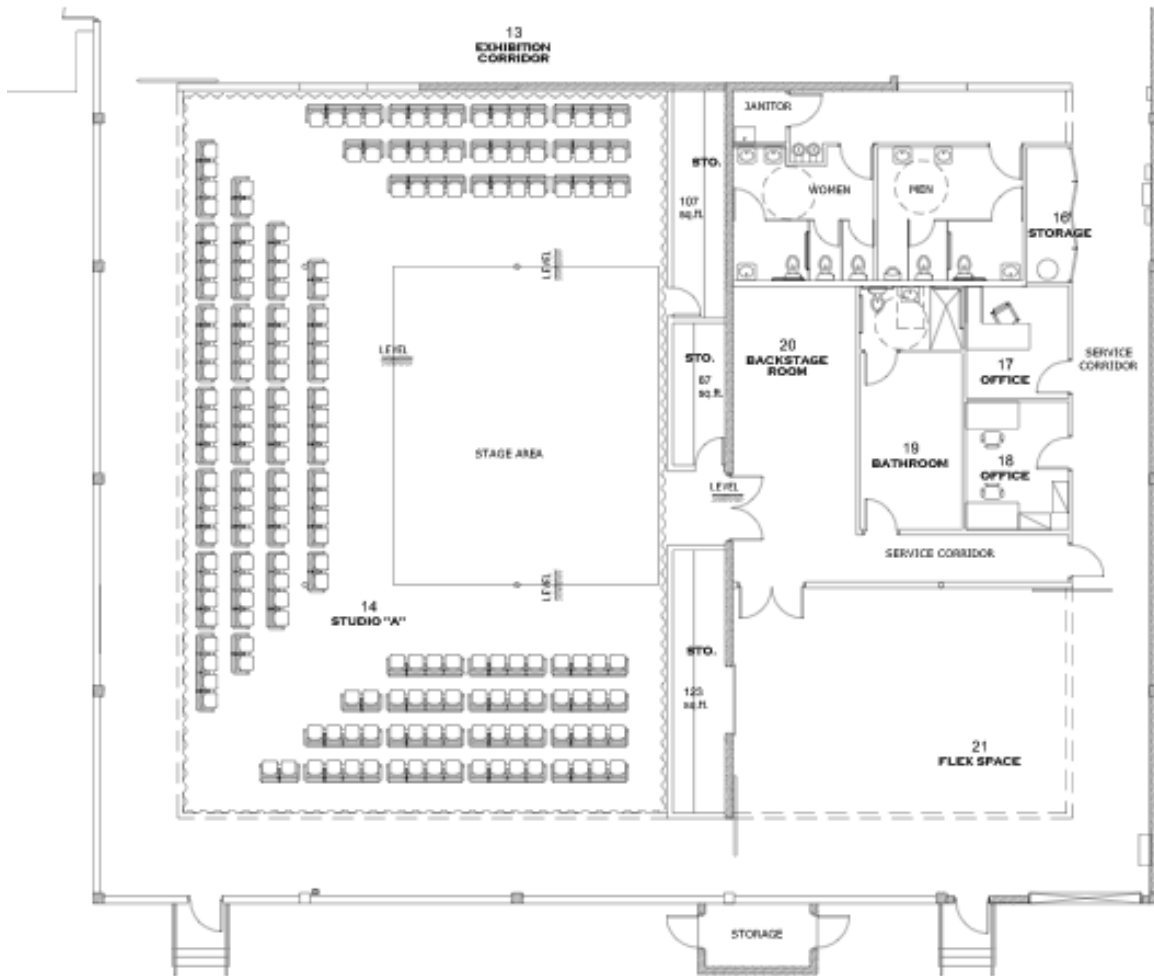

***Seat placement/count not exact, just a reference.**

Studio A Theatre
Scale: 1/4" = 1'-0"
GRID HEIGHT 13'5"

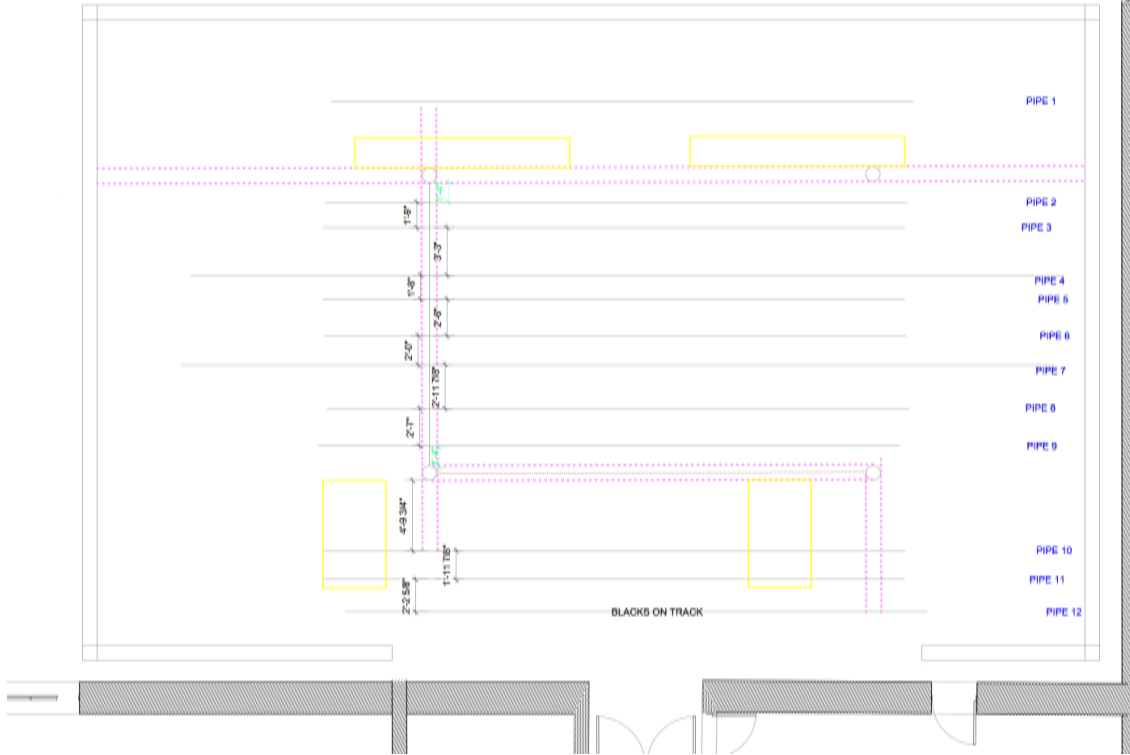

(Upstage side)

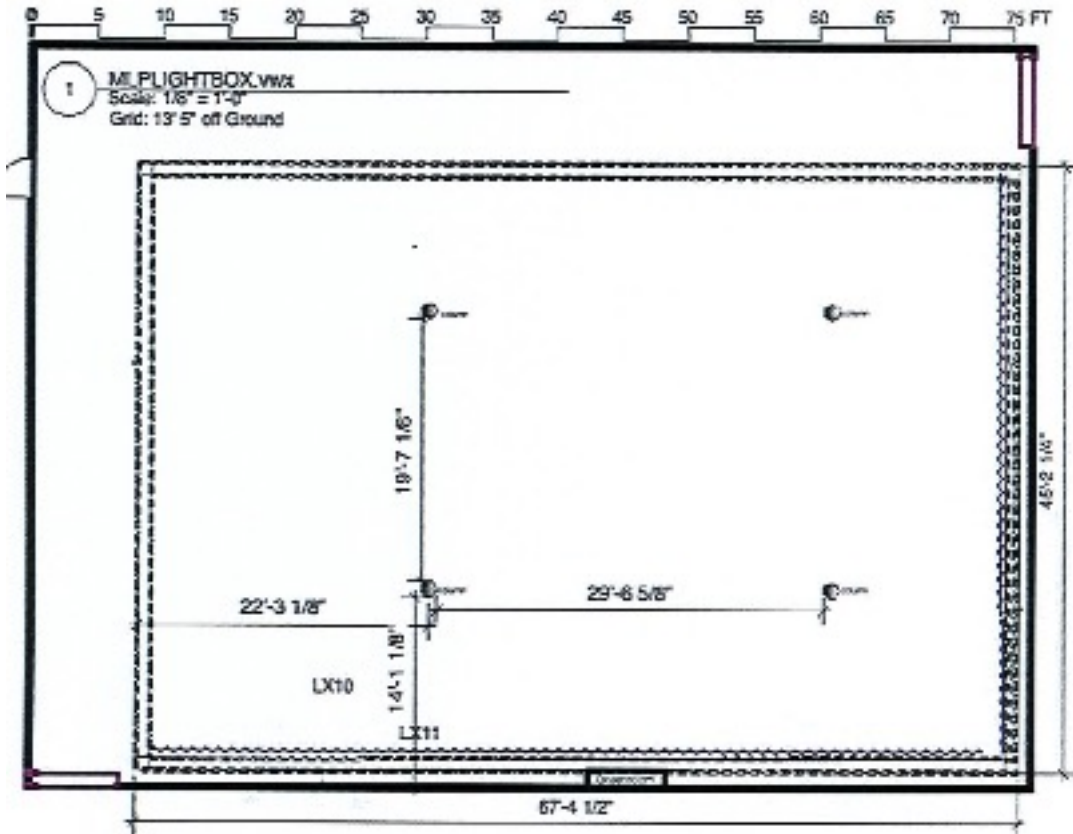

(upstage side) / Circles reference pillars in room around stage

***All inventory is subject to change due to repairs/rentals**

Electrics

The renter is responsible for all crew labor expenses to hang, strike, and restore lighting.

Control

- 1 Martin M2GO with Touch Screen Interface *Main console we use
- 1 ETC Express 24/48

Distribution

- 1 ETC Sensor 1220B 12 Channelx2400W
- 15 Leviton D4DMX-MD3 4Channel 1200W
- 7 Socorex 6 Circuit runs from dimmer room into Studio A

Conventional Instrument Inventory

- 35 ETC Source 4 Bodies (all 575)
 - 8 26degrees lens
 - 16 36degree lens
 - 16 50degree lens

- 6 ETC Source 4 Jr. Zoom 36-50degree
- 11 ETC Source 4 Parnel
- 9 ETC Source 4 Pars Wide (med/narrows available)
- 2 Altman Fresnel 65Q 750w
- 4 Birdies

LED Instrument Inventory

- 8 Chauvet Colorado 2 Zoom Tour PAR
- 8 Chauvet Batten 72

ACCESSORIES

Quantity Type

- 3 Par Barn Doors
- 9 "A" Size Gobo Holder
- 5 "B" Size Gobo Holder
- 5 JR S4 Gobo Holder
- 2 drop in iris

Cabling

Quantity Type

- 5 3' Edison Soco Break-Ins
- 3 3' Stagepin Soco Break-outs
- 3 3' Stagepin Soco Break-Ins
- 7 6' Stagepin Soco Break-outs
- 7 100' Soco cable
- 4 5' Stagepin
- 7 10' Stagepin
- 23 25' Stagepin
- 1 50' Stagepin
- 1 50' Stagepin
- 8 Stagepin Female to Male Edison Turnaround
- 7 Stagepin Male to Edison Female Turnaround
- 12 Stagepin 2Fers

Lighting FX / Miscellaneous

Quantity Type

- 1 Apollo Indexing TwinSpin
- 1 18" Mirror Ball with Motor
- 1 4" Halogen Light
- 8 2x2 Floor Mounts (black)
- 4 12" Cliplight
- 3 6" Cliplight

Cabling

Quantity	Type
7	10' DMX (3pin)
5	25' DMX (3pin)
3	5' DMX (5pin)
2	25' DMX(5pin)
10	10' Edison
1	5' Edison
2	10' Edison Multi
7	20' Edison
11	15 AMP Powerstrip

Houselights

Control via Front Theatre Door Entrance + Dimmer located adjacent to light board

Booth / Tech Table

FOH located on house right side. Booth can be relocated to different locations (additional charges may apply)

Audio

Control

- 1 Mackie 1402 VLZ
 - 1 Allen & Heath GL 2400-24ch w/24 ch snake
 - 1 Yamaha Ls9 w/32 ch snake (not guaranteed but available upon request)
- Mix position from booth at FOH House Right*

Outboard Equipment

- 1 Ashly Dual 31 Band 1/3 Octave
- 2 Numark Rackmount CD/MP3
- 1 DBX USL 31 band EQ
- 1 MX400TRS – Lexicon- 4-channel Multi
- 1 Scm4 Samson 4-channel

Speakers / Amp

- 4 QSC K10
- 2 QSC KSUB (w/2 pole mounts)
- 1 BGW GTB
- 2 EVs
- 2 Yamaha DXR 15"
- 2 Electro Voice ELX 112P
- 2 QSC PL 380 Amps (not guaranteed)
- 2 Dynacord Cobra PWH Subs (not guaranteed)
- 4 JBL EON 615 stage monitors

Microphones & DI

2 Senheisser G3 Wireless Handheld
4 Shure SM 58
1 Sony ECM 670
2 Audix i5
1 Audio Technica
2 SM 57
3 Stero DI

Stands

3 Tabletop Mic Stands
4 Quick lock straight Mic Stands
1 Boom Mic Stands
2 Drum Clips
2 Guitar Stands
6 Music Stands

Backline

DJ Equipment

1 Denon DHX 120 mixer
1 Stanton RM416 Mixer

Drum Kit

DW Designer Series DDLG2215TB Maple Shell
1 18" x 22" Bass Drum
1 8" x 10" Tom
1 9" x 12" Tom
1 14" x 16" Floor Tom
1 5.5" x 14" Snare
1 Throne

Cables

9 25' XLR
11 10' XLR
2 5' XLR
2 2' XLR
1 5' 4CH TRS Snake
1 10' 2xMono 1/4Jack Male
2 3' Stereo 1/4Male to XLR Male
1 3' Stereo 1/4Male to XLR Female
1 3' Stereo 1/4 Male to RCA Female
1 5' 1/8Male to RCA Male
1 10'Male RCA to Male RCA
1 5'Male RCA to Male RCA
1 25' 1/4Male RCA to Male RCA
2 10' Mono 1/4 to Mono 1/4Male

Video

- 1 Fold Screen 9' x 10' Screen Kit with legs

Projectors/ Switchers

- 1 BEN Q MW814ST
- 1 Sanyo WUXGA
- 1 Blackmagic Design ATEM Switcher

Dvd Players

- 1 LG Bluray
- 1 Sony dvd
- 1 Sony Bluray
- 1 Hp dvd1170

Cameras

- 2 Sony Handycam PJ 230
- 2 Tri pods

Cables & Accessories

- 4 100' VGA
- 1 50' VGA
- 1 10' Component
- 1 100' HDMI
- 3 50' HDMI
- 3 100' SDI
- 2 Black Magic Design HDMI to SDI
- 3 Thunderbolt to VGA
- 3 Thunderbolt to HDMI
- 2 PC to HDTV
- 1 HDMI Splitter
- 2 Spare computer monitors

Staging & Seating

Floor Options

- 6 30' x 5' flat black/white Marley
- 1 8'x4' Marley square
- 2 28'x28' Sprung Dance floors (Ash wood in studio B, Maple wood in Studio A)

*Moving of the marley has a \$50 charge

Decking

- 8 8'x4' Decks
 - 1 4'x4' Deck
- Legs for decks are 14" or 22"

Soft Goods

(Black Box)

- 10.....Double Sided Panel 1: 16 oz. Black FR Velour - 12'-0" W x 13'-4" H, flat.
- 2Single Panel 12'-0" W x 13'-4" Flat
- 1.....Seamless White Muslin CYC 13'5" H X 30' W

(White Box)

- 4.....White Full Curtains

*Curtains are set and fees may occur to move these curtains.

Accessories

- 4 25lbs sandbags
- 1 12' Ladder
- 1 10' Ladder
- 1 8' Ladder

Seating

- 7 10' 3tier Black risers
- 200 Black Covered Banquet Chairs (used as audience seating for studio A)
- 35 Black Cushioned arm chairs
- 5 Black aluminum folding chairs
- 4 Director Chairs

Tables

- 2 8'rectangle table
- 7 6'rectangle table
- 1 4'rectangel table
- 1 3'x5" round table
- 9 Cocktail rounds (tall/short height available)

Backstage

Loading Dock

Location 1: on 25th street behind the theatre for small trucks/vans

Location 2: on 26th street in front of building for larger trucks

Trucks One at a time

Dressing Rooms

- 1 Dressing room w/private bathroom with shower
- 1 Green room shared with tech storage area

Internet

Wifi available; check with the Technical Director for more information.

General Information

Theatre Address

404 Northwest 26th Street

Miami, FL 33127

(305)576-4350

www.miamilightproject.com

Contact Information

Rentals Manager:

Isis Blanco

isis@miamilightproject.com

Technical Director:

Kristina Villaverde

kristina@miamilightproject.com

Artistic Director & Executive Director:

Beth Boone

beth@miamilightproject.com